



QF 13-Series Standard AC Range

Very compact hydraulic magnetic circuit breaker for space-saving distributions and various forms of device protection. The CBI series QF 13 frame consists of modular AC breakers in a rated current range of 1-25A with a 6kA breaking capacity. The QF frame circuit breakers are IEC, UL and CCC approved. For ratings or configurations not covered in the list, please contact us.

Features

- AC circuit breaker
- Hydraulic-magnetic technology
- 100% rating capability, independent of ambient temperature
- VC 8036 compliant (SANS 556-1)
- VDE, EAC and CCC approved, CE certified
- AS/NZS 3111 approved
- Ratings 1 A to 25 A
- Precision tripping characteristics
- Ultra compact – 13 mm wide module
- Trip indication with mid-trip position
- Can be switched on immediately after tripping
- DIN mount, 45 mm front escutcheon (Grey)
- Suitable to use for electrical isolation
- Shell designed for easier installation onto busbar

Applications

- AC branch circuit protection (DIN / EN 60947-2)
- Switch disconnecter (DIN / EN 60947-3)
- Telecom / datacom equipment
- Lighting control
- UPS equipment
- Alternative energy equipment
- Mobile power generation equipment
- Railway signaling equipment
- Residential equipment
- Industrial equipment

Technical data

DATA	
Product Type	Circuit Breaker
Approvals	DIN / EN 60947-2, VDE, CE, EAC, CCC, UL1077
Number of Poles	1
Operating Voltages	240VAC
Minimum Current Rating	1A
Maximum Current Rating	25A
Interrupting Capacity	6kA
Mounting Options	-40° C - +85° C
Tripping Curves Medium time delay	2

Auxiliary Switch, Trip Alarm & Combo: Features - contact Emcomp

- Handle lock - QFAP001
- Surface mounting clips - SAAX000
- Busbar - SABBM54
- 57 mm escutcheon blank (Dual mount only) - 235608
- 57 mm safety blank (Dual mount only) - SAEB000 Optional Accessories
- Factory fitted
- Attached to right hand side of the circuit breaker
- Compact 6.5 mm width
- Auxiliary switch + trip alarm (Dual mount only)
- Trip alarm (Dual mount only)
- UL 489 listed & IEC 60947-5-1
- Industrial equipment

Optional Accessories - contact Emcomp

- Handle lock - QFAP001
- Surface mounting clips - SAAX000
- Busbar - SABBM54
- 57 mm escutcheon blank (Dual mount only) - 235608
- 57 mm safety blank (Dual mount only) - SAEB000

PRODUCT	
Item No	Rated Current
QFB18201	1A
QFB18202	2A
QFB18203	3A
QFB18204	4A
QFB18206	6A
QFB18210	10A
QFB18216	16A
QFB18220	20A
QFB18225	25A

Medium Time Delay Curve-2

Outline Dimensions: DIN Mount

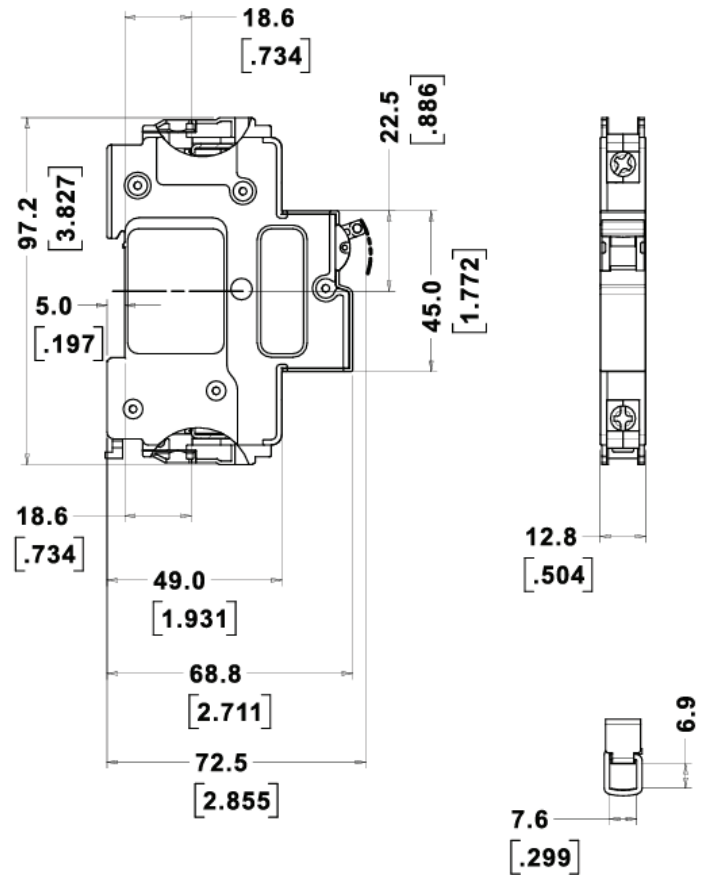
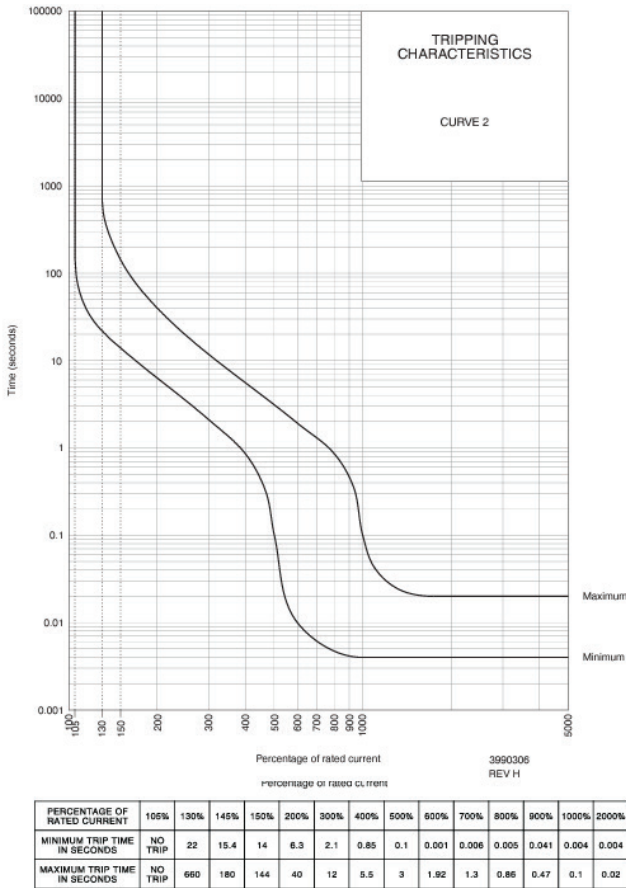

Handle lock

Do you need to ensure that the breaker is not tripped unintentionally? Emcomp has a solution! A handle lock for the Q series. The Q series, has a special lock that make it possible to lock the handle in the on or off position. The lock can be further secured with a pad lock if necessary.

This can be valuable if you have a load that not should be switched off, or vice versa, if you have a load that absolutely not should be switched on, for instance during maintenance work etc.

The circuit breaker can of course still trip if you have an overload or a short circuit even if the handle is locked in the on position.



Thermal-Magnetic vs Hydraulic-Magnetic

Thermal with no spacing

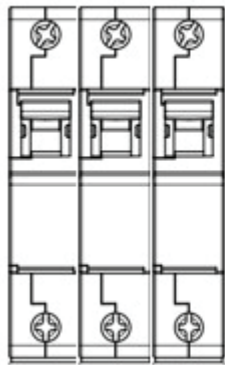

Thermal with spacing

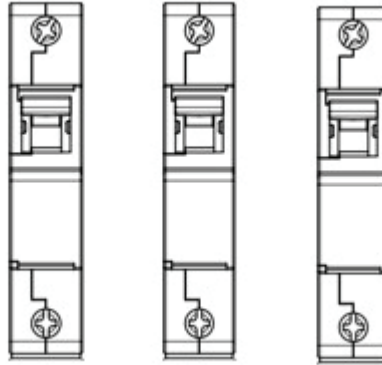

Hydraulic-Magnetic with no spacing

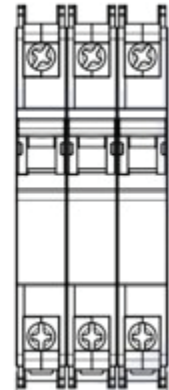

Nominal current	16A	16A	16A
Operating at 30° C	10.8A	11.9A	16A
Operating at 45° C	9.6A	10.6A	16A

Due to the Hydraulic-Magnetic technology the MCB will keep rated current regardless of the ambient temperature. No de-rating needed.

Advantages:

- Not sensitive to ambient temperatures
- Always keep rated current regardless of temperature, classified from -40° to 85° C
- Dedicated AC and DC products with correct approvals
- Immediate re-set after tripping –no cooling down period
- World wide approval profile
- Possibility to customize products
- Energy efficient alternative –45% lower internal resistance

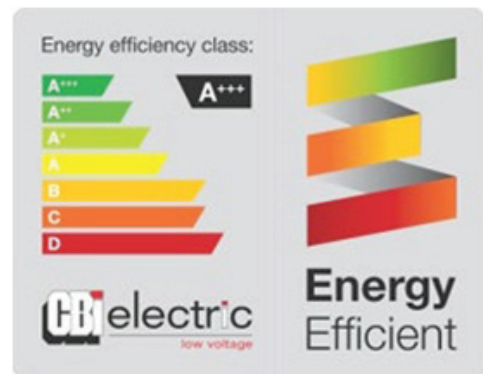

Telecom



Renewable Energy & Energy Storage



Data Center



Rolling Stock & Signalling



Marine & Offshore

Contact us • www.emcomp.se • info@emcomp.se

Emcomp International AB, Tomtagatan 17, 702 32 Örebro, Sweden, +46 (0)581 62 15 50